



14 Catcliffe Cottages, Bakewell, Derbyshire, DE45 1FL

Saxton Mee

14 Catcliffe Cottages

Asking Price

£265,000

This delightful two-bedroom mid-terrace cottage is full of character and charm, offering accommodation arranged over three floors. With an attractive front garden, a private rear courtyard and useful outbuildings, the property occupies an elevated position in the historic market town of Bakewell, enjoying superb views towards the church and surrounding Peak District countryside.

Ideally located close to a wide range of local shops, country inns and amenities, the cottage makes a perfect main residence or holiday retreat. It provides easy access to picturesque walks, nearby villages and cycle trails, making it an excellent base for exploring the area.

Inside, the cottage retains many original features, including a cosy sitting room with a gritstone fireplace and gas stove. The fitted dining kitchen is well laid out and opens directly onto the rear terrace, creating a seamless link between indoor and outdoor living.

On the first floor, there is a spacious double bedroom and a bathroom.

The second floor boasts a generous double bedroom with far-reaching views across the surrounding countryside.

Outside, the front garden includes a pleasant seating terrace, while the rear courtyard offers a manageable and private space with additional storage. The current owners rent a parking space in a nearby car park.

This charming cottage is offered with no upward chain and presents a rare opportunity to own a characterful home in one of Derbyshire's most desirable locations.



- Superb Far Reaching Views
- Retaining Original Character Features
- Easy Reach Of Town Centre Amenities
- Attractive Garden
- Allocated Parking Space Available To Rent
- Ideal Main Home
- Currently Run As A Holiday Cottage
- No Upward Chain
- EPC: D
- Viewings: Bakewell Office





14 Catcliffe Cottages

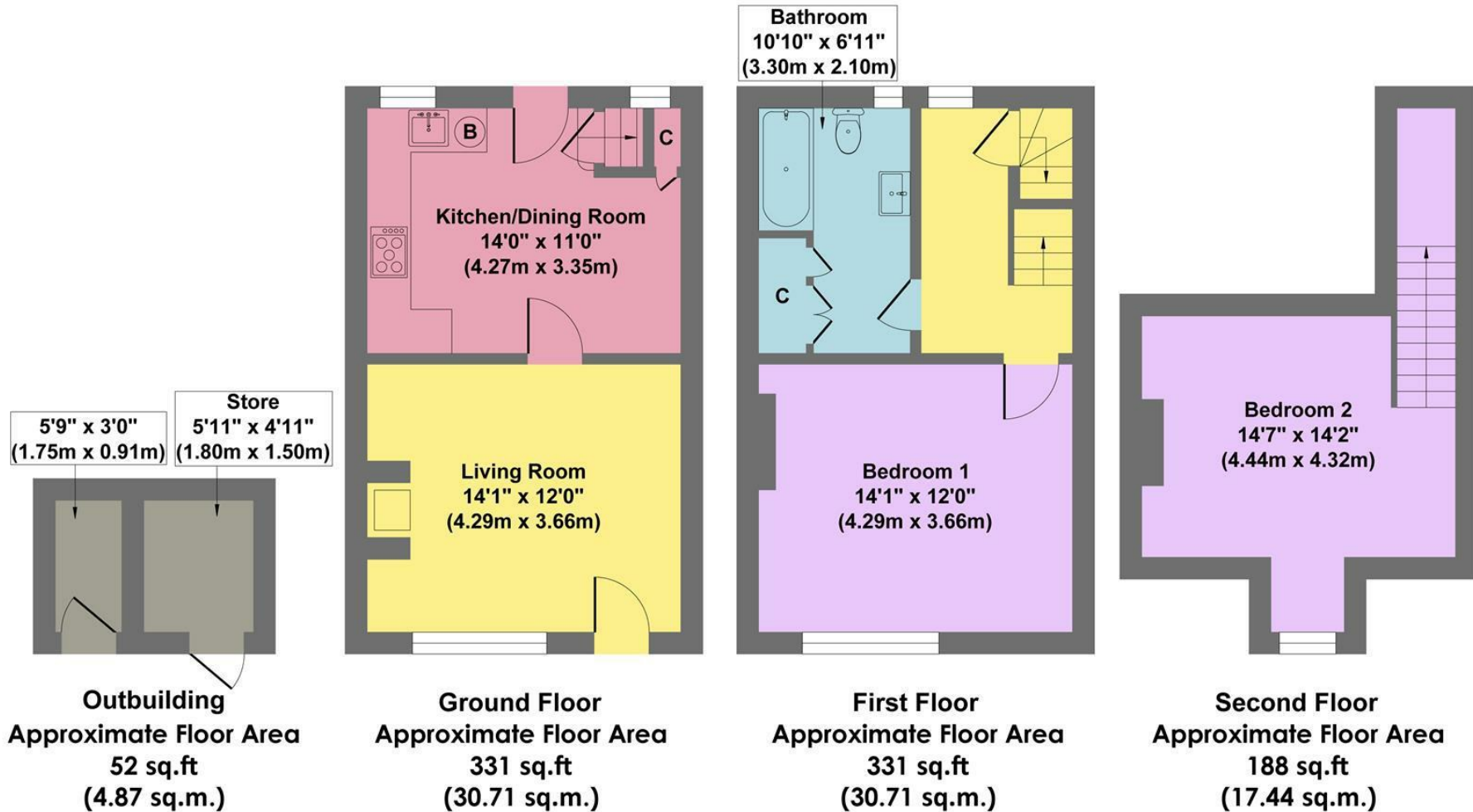

Approx. Gross Internal Floor Area 902 sq.ft / 83.73 sq.m

Illustration for identification purposes only, measurements are approximate, not to scale

While we endeavour to make our sales particulars fair, accurate and reliable, they are only a general guide to the property and, accordingly, if there is any point, which is of particular importance to you, please contact the relevant office. The Agents have not tested any apparatus, equipment, fittings or services and so cannot verify they are in working order. The buyer is advised to obtain verification. Please note all the measurement details are approximate and should not be relied upon as exact. All plans, floor plans and maps are for guidance purposes only and are not to scale. Under no circumstances should they be relied upon as exact or for use in planning carpets and other such fixtures, fittings or furnishings. YOUR HOME IS AT RISK IF YOU DO NOT KEEP UP REPAYMENTS ON A MORTGAGE OR OTHER LOAN SECURED ON IT. 'A Life Assurance policy may be requested.' 'Written Quotations of credit terms available on request.'

Banner Cross
T: 0114 268 3241
E: bannercross@saxtonmee.co.uk
www.saxtonmee.co.uk

Hathersage
T: 01433 650009
E: hathersage@saxtonmee.co.uk

Bakewell
T: 01629 815307
E: bakewell@saxtonmee.co.uk

Matlock
T: 01629 828250
E: matlock@saxtonmee.co.uk

